

PROFESSIONAL SUPPLIER FOR MARINE & INDUSTRIAL PRODUCTS



FRANK MARINE PTY LTD



QUALITY MARINE & INDUSTRIAL PRODUCTS

FRANK MARINE PTY LTD

Unit 8, 103 Lewis Road, Knoxfield, VIC 3180
Ph: (03)9887 3879 Fax: (03)8677 9681
info@frankmarine.com.au www.frankmarine.com.au





COMPANY PROFILE

Frank Marine Pty Ltd is a professional supplier for high quality boat hardware, rigging hardware, shade sail fittings, balustrade hardware and fastener hardware, rope, and various marine and industrial products, located in Melbourne, Australia.

The main goods are as follows, including but not limited to:

1. Boat Anchor: Plough Anchor, Sand Anchor, Self Align Anchor (Claw Anchor), Folding Anchor. Both galvanized anchor and stainless steel 316 anchor are available.
2. Deck Hardware: cleat, bollards, chock, deck fill, thru hull outlet and intake strainer, antenna base, deck plate, stanchion, deck fittings.
3. Canopy fittings: top cap, jaw slide, deck hinge, side mount, inside eye end.
4. Hinge: Door Hinge, Butt Hinge, Strap Hinge, Offset Hinge, Take Apart Box Hinge.
5. Shackle: Dee Shackle, Bow Shackle, Long Dee Shackle, Twisted Shackle.
6. Hook: Snap Hook, Spring Gate Snap, Swivel Eye Snap, Fixed Eye Hook, Snap Shackle and S Hook.
7. Turnbuckle: Open Body Turnbuckle, Bottlescrew, Swage Stud Terminal, Eye Terminal, and Fork Terminal.
8. Pad Eye and U-Bolt: Round Pad Eye, Diamond Pad Eye, Oblong Pad Eye, Rectangular Pad Eye, Saddles, Staples, U bolts and etc.
9. Eye Bolt and Eye Nut: Welded Eye Bolt, Casted Eye Bolt and Nut, Lag Eye Screw.
10. Chains: General Link Chain and Short Link Chain. Both galvanized chains and stainless steel chains are available.
11. Swivel, Wire Rope Grip, Thimble.
12. Stainless Steel Wire Rope: 1x19, 7x19, 7x7 Wire Rope.
13. Rope: Silver Rope, Nylon Three Strand Rope, Polyester Rope.
14. Valve and Fittings.
15. Fishing Rod Holders.

Frank Marine is always glad to make and supply the new items for you as per your samples or drawings.

STAINLESS STEEL SHACKLES



FORGED DEE SHACKLES with screw pin

Art. No.	Dia.	Inside Width	Inside Length	Breaking Load (kg)
20004	4mm	8mm	16mm	550
20005	5mm	10mm	20mm	1000
20006	6mm	12mm	24mm	1700
20008	8mm	16mm	32mm	2500
20010	10mm	20mm	40mm	4100
20012	12mm	24mm	48mm	5400
20016	16mm	32mm	64mm	8800
20019	19mm	38mm	76mm	10000



FORGED BOW SHACKLES with screw pin

Art. No.	Dia.	Bow Width	Inside Length	Breaking Load (kg)
20104	4mm	14mm	16mm	550
20105	5mm	17mm	20mm	1000
20106	6mm	21mm	24mm	1700
20108	8mm	28mm	32mm	2500
20110	10mm	34mm	40mm	4100
20112	12mm	42mm	48mm	5400
20116	16mm	56mm	64mm	8800
20120	20mm	66mm	76mm	10000



FORGED DEE SHACKLES with captive pin

Art. No.	Dia.	Inside Width	Inside Length	Breaking Load (kg)
23004	4mm	8mm	16mm	500
23005	5mm	10mm	20mm	1000
23006	6mm	12mm	24mm	1400
23008	8mm	16mm	32mm	2300
23010	10mm	20mm	40mm	4000
23012	12mm	24mm	48mm	5300



FORGED BOW SHACKLES with captive pin

Art. No.	Dia.	Bow Width	Inside Length	Breaking Load (kg)
23104	4mm	14mm	16mm	500
23105	5mm	17mm	20mm	1000
23106	6mm	21mm	24mm	1400
23108	8mm	28mm	32mm	2300
23110	10mm	34mm	40mm	4000
23112	12mm	42mm	48mm	5300





FORGED LONG DEE SHACKLES with screw pin

Art. No.	Dia.	Inside Width	Inside Length	Breaking Load (kg)
21005	5mm	10mm	40mm	1250
21006	6mm	12mm	48mm	1800
21008	8mm	16mm	64mm	2750
21010	10mm	20mm	80mm	4250
21012	12mm	24mm	96mm	6400



DEE SHACKLE—Hot Dipped Galvanized for general applications. Not rated for lifting purposes

Art. No.	Dia.
28005	5mm
28006	6mm
28008	8mm
28010	10mm
28012	12mm
28014	14mm
28016	16mm
28018	18mm
28019	19mm
28020	20mm



FORGED LONG DEE SHACKLES with captive pin

Art. No.	Dia.	Inside Width	Inside Length	Breaking Load (kg)
21305	5mm	10mm	40mm	1250
21306	6mm	12mm	48mm	1800
21308	8mm	16mm	64mm	2750
21310	10mm	20mm	80mm	4250
21312	12mm	24mm	96mm	6400



BOW SHACKLE—Hot Dipped Galvanized for general applications. Not rated for lifting purposes

Art. No.	Dia.
28105	5mm
28106	6mm
28108	8mm
28110	10mm
28112	12mm
28114	14mm
28116	16mm
28118	18mm
28119	19mm
28120	20mm



FORGED TWISTED SHACKLES with screw pin

Art. No.	Dia.	Inside Width	Inside Length	Breaking Load (kg)
22005	5mm	10mm	30mm	1100
22006	6mm	12mm	36mm	1600
22008	8mm	16mm	48mm	2800
22010	10mm	20mm	60mm	4500
22012	12mm	24mm	72mm	6500

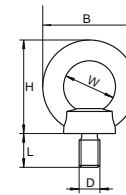

EYE BOLT - DIN 580

Art. No.	D	B	L	W	H	Breaking Load (kg)
78006	6mm	28mm	12mm	15mm	31mm	1300
78008	8mm	36mm	13mm	20mm	36mm	2000
78010	10mm	45mm	17mm	25mm	45mm	2600
78012	12mm	54mm	21mm	30mm	53mm	3900
78016	16mm	63mm	27mm	35mm	62mm	7000
78020	20mm	72mm	30mm	40mm	71mm	10000
78024	24mm	90mm	36mm	50mm	90mm	12000

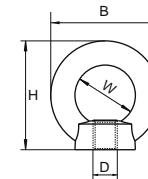

EYE NUT - DIN 582

Art. No.	D	B	W	H	Breaking Load (kg)
79006	6mm	28mm	16mm	32mm	1100
79008	8mm	36mm	20mm	36mm	1300
79010	10mm	45mm	25mm	45mm	2600
79012	12mm	54mm	30mm	53mm	3400
79016	16mm	63mm	35mm	62mm	7000
79020	20mm	72mm	40mm	71mm	10000
79024	24mm	90mm	50mm	90mm	12000



EYE NUT

Art. No.	Size	Breaking Load (kg)
79106	M6	1100
79108	M8	1300
79110	M10	2600
79112	M12	3400
79116	M16	8000



RING BOLT

Art. No.	Size	Thread Length	Eye Dia.	Breaking Load (kg)
77106	6mm	50mm	35mm	800
77108	8mm	50mm	45mm	1800
77110	10mm	75mm	50mm	2400
77112	12mm	80mm	60mm	3000

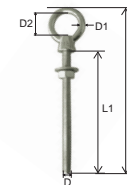

EYE BOLT - investment cast and welded

Art. No.	D	L1	D1	D2	b	Breaking Load (kg)
77640	6mm	40mm	5mm	15mm	70mm	1100
77660	6mm	60mm	5mm	15mm	90mm	1100
77611	6mm	80mm	5mm	15mm	110mm	1100
77880	8mm	80mm	6mm	20mm	120mm	1300
77814	8mm	100mm	6mm	20mm	140mm	1300
77107	10mm	120mm	8mm	25mm	170mm	2600
77122	12mm	140mm	10mm	30mm	200mm	3400

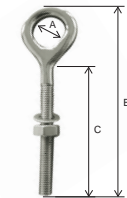

WELDED EYE BOLTS - formed and welded

Art. No.	Size	A	B	C	Breaking Load (kg)
77211	6mm	13.10mm	70mm	40mm	1000
77212	6mm	13.10mm	90mm	60mm	1000
77213	8mm	17.20mm	120mm	80mm	1800
77214	10mm	21.50mm	150mm	100mm	2400
77215	12mm	25.50mm	140mm	80mm	3500

BOTTLESCREW Jaw/Jaw

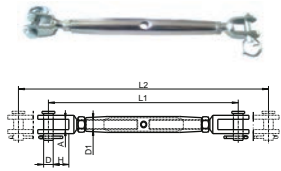

Art. No.	Dimension (mm)						
	D1	L1	L2	D	A	H	Breaking Load (kg)
80705	5	130	190	5	6,5	10	750
80706	6	150	220	6	7,5	10	1400
80708	8	165	240	8	11,0	11	2200
80710	10	190	280	9	12,0	14	3450
80712	12	245	360	12	14,0	20	5000
80714	14	270	390	12	15,0	22	5800
80716	16	310	450	16	17,0	26	8000
80720	20	360	510	19	20,0	30	13000

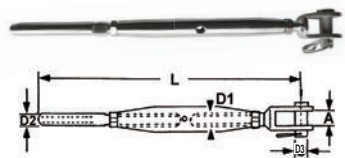

BOTTLESCREW Jaw/Swage terminal

Art.No.	D1	D2	L(Min)	L(Max)	A	D3	Breaking Load (kg)
80805-1	M5	3/32"	150	210	7.0	5	600
80805-2	M5	1/8"	155	215	7.0	5	600
80806-1	M6	1/8"	170	238	7.5	6	1000
80806-2	M6	5/32"	180	245	7.5	6	1000
80808-1	M8	5/32"	190	280	11	8	1400
80808-2	M8	3/16"	200	300	11	8	1400

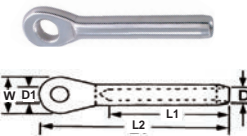

WIRE ROPE SWAGE EYE TERMINAL

Art. No.	D	W	D1	L1	L2	Breaking Load (kg)
46502	3/32"-2.4mm	13	5.4	30	55	850
46503	1/8"-3.2mm	14	6.5	36	65	1000
46504	5/32"-4mm	18	8.5	40	75	1350
46505	3/16"-4.8mm	22	10	50	88	2500
46506	1/4"-6.3mm	28	13	62	108	4500

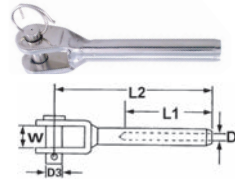

WIRE ROPE SWAGE FORK TERMINAL, welded

Art. No.	D	W	D3	L1	L2	Breaking Load (kg)
46802	3/32"-2.4mm	7	5	30	55	700
46803	1/8"-3.2mm	7.5	6	32	65	1250
46804	5/32"-4mm	11	8	40	77	1800
46805	3/16"-4.8mm	12	8	55	88	2650
46806	1/4"-6.3mm	14	12	63	105	4000

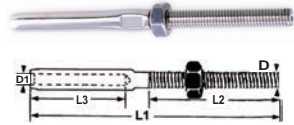

WIRE ROPE SWAGE STUD with nut

Art. No.	D	D1	L1	L2	L3
46605	M5	1/8"-3.2mm	86	40	32
46606-1	M6	3/32"-2.4mm	75	40	32
46606-2	M6	1/8"-3.2mm	95	45	39
46606-3	M6	5/32"-4mm	110	48	40
46608-1	M8	5/32"-4mm	115	55	45
46608-2	M8	3/16"-4.8mm	120	55	45
46610	M10	1/4"-6.3mm	155	80	64



TURNBUCKLE Eye/Eye

Art.No.	Size	Eye Dia.	Length(Min)	Length(Max)	Breaking Load (kg)
81605	5mm	10mm	120	170	650kg
81606	6mm	12mm	150	220	1500kg
81608	8mm	14mm	200	290	2000kg
81610	10mm	16mm	250	350	3000kg
81612	12mm	19mm	320	470	4000kg
81616	16mm	22mm	370	600	8000kg



TURNBUCKLE Hook/Hook

Art.No.	Size	W	Length(Min)	Length(Max)	Breaking Load (kg)
81805	5mm	8mm	120	170	650
81806	6mm	10mm	150	220	1500
81808	8mm	11mm	200	290	2000
81810	10mm	12mm	250	350	3000
81812	12mm	16mm	320	470	4000



TURNBUCKLE Hook/Eye

Art.No.	Size	W	Length(Min)	Length(Max)	Breaking Load (kg)
81705	5mm	8mm	120	170	700
81706	6mm	10mm	150	220	1500
81708	8mm	11mm	200	290	2000
81710	10mm	12mm	250	350	3000
81712	12mm	16mm	320	470	4000



TURNBUCKLE Jaw/Jaw

Art.No.	Size	A	L(Min)	L(Max)	Breaking Load (kg)
81905	5mm	10mm	110	170	650
81906	6mm	10mm	130	200	1400
81908	8mm	11mm	180	270	2000
81910	10mm	12mm	220	330	3400
81912	12mm	14mm	280	450	4500



CLOSED BODY RIGGING TURNBUCKLE with turned jaws

Art. No.	size	L1(mm)	L2(mm)	C(mm)	D(mm)	Breaking Load (kg)
80005	5mm	120	175	5	5	750
80006	6mm	135	190	6	6	1400
80008	8mm	160	230	6	8	2200
80010	10mm	180	260	8	10	3300
80012	12mm	225	325	8.5	12	4800
80014	14mm	260	385	10	14	5800
80016	16mm	300	440	12	16	8000
80020	20mm	385	580	14	20	13000

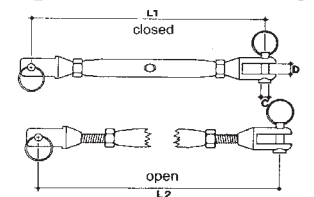



U BOLTS turned with nuts and double plates

Art. No.	Size	Thread	Length
72501	M5	x 35mm x 78mm	
72502	M6	x 35mm x 90mm	
72503	M8	x 35mm x 80mm	
72504	M8	x 45mm x 100mm	
72505	M10	x 50mm x 115mm	
72506	M12	x 60mm x 120mm	
90670	M6 X	28mm x 70mm	



U BOLTS with two nuts and one plate

Art. No.	Size	Art. No.	Size
72001	4x60mm	72007	8x80mm
72002	5x60mm	72008	8x100mm
72003	5x80mm	72009	10x90mm
72004	6x80mm	72010	10x130mm
72005	6x90mm	72011	12x150mm
72006	8x60mm		



U BOLTS with four nuts and two plates

Art. No.	Size	Art. No.	Size
72301	4x60mm	72307	8x80mm
72302	5x60mm	72308	8x100mm
72303	5x80mm	72309	10x90mm
72304	6x80mm	72310	10x130mm
72305	6x90mm	72311	12x150mm
72306	8x60mm	72816	10X140mm
72822	12x135mm	72840	12X165mm



SWIVEL EYE/EYE

Art. No.	Size	Length	Breaking Load (kg)
76105	5mm	60mm	650
76106	6mm	65mm	1200
76108	8mm	90mm	1900
76110	10mm	115mm	3500
76113	13mm	154mm	5000
76116	16mm	188mm	8500



SWIVEL EYE/JAW

Art. No.	Size	Length	Breaking Load (kg)
76206	6mm	66mm	1200
76208	8mm	94mm	1900
76210	10mm	118mm	3500
76213	13mm	152mm	5000
76219	19mm	229mm	8500



SWIVEL JAW/JAW

Art. No.	Size	Length	Breaking Load (kg)
76306	6mm	66mm	1200
76308	8mm	94mm	1900
76310	10mm	118mm	3500
76313	13mm	152mm	5000
76316	16mm	188mm	8500



SNAP HOOKS

Art. No.	Dia.	Length	Open Dia.	Breaking Load (kg)
82005	5mm	50mm	8mm	220
82006	6mm	60mm	9mm	270
82007	7mm	70mm	9mm	360
82008	8mm	80mm	10mm	500
82010	10mm	100mm	12mm	600
82011	11mm	120mm	16mm	800
82012	12mm	140mm	20mm	900
82013	13mm	160mm	26mm	1000



SNAP HOOKS with thimble eye

Art. No.	Dia.	Length	Open Dia.	Eye Dia.	Breaking Load (kg)
82105	5mm	50mm	8mm	7.5mm	220
82106	6mm	60mm	9mm	9mm	270
82107	7mm	70mm	9mm	10mm	360
82108	8mm	80mm	10mm	11.5mm	500
82110	10mm	100mm	12mm	14mm	600
82111	11mm	120mm	16mm	16.5mm	800
82112	12mm	140mm	20mm	18mm	900
82113	13mm	160mm	26mm	20mm	1000



SNAP HOOKS with safety screw

Art. No.	Dia.	Length	Open Dia.	Breaking Load (kg)
82206	6mm	60mm	9mm	450
82207	7mm	70mm	9mm	580
82208	8mm	80mm	10mm	720
82210	10mm	100mm	12mm	1090
82211	11mm	120mm	16mm	1200
82212	12mm	140mm	20mm	1460



SNAP HOOKS with thimble eye, safety screw

Art. No.	Dia.	Length	Open Dia.	Eye Dia.	Breaking Load (kg)
82606	6mm	60mm	9mm	9mm	450
82607	7mm	70mm	9mm	10mm	580
82608	8mm	80mm	10mm	11.5mm	720
82610	10mm	100mm	12mm	14mm	1090
82611	11mm	120mm	16mm	16.5mm	1200
82612	12mm	140mm	20mm	18mm	1460



ASYMMETRIC SNAP HOOKS

Art. No.	Dia.	Length	Open Dia.	Breaking Load (kg)
82306	6mm	60mm	10mm	500
82308	8mm	80mm	14mm	800
82310	10mm	100mm	20mm	1500
82311	11mm	120mm	24mm	2000



ASYMMETRIC SNAP HOOKS with thimble eye

Art. No.	Dia.	Length	Open Dia.	Breaking Load (kg)
82406	6mm	60mm	10mm	500
82408	8mm	80mm	14mm	800
82410	10mm	100mm	20mm	1500
82411	11mm	120mm	24mm	2000



SPRING GATE SNAPS

Art. No.	Length	Width	Breaking Load (kg)
86001	50mm(2")	25mm(1")	220
86002	70mm(2-3/4")	31mm(1-1/4")	500
86003	100mm(4")	50mm(2")	900



SPRING HOOKS

Art. No.	Dia.	Length	Breaking Load (kg)
85006	6mm(1/4")	60mm(2-3/8")	750
85008	8mm(5/16")	80mm(3-1/16")	1750
85010	10mm(3/8")	100mm(4")	2250
85012	12mm(1/2")	120mm(4-3/4")	3650



FIXED EYE SNAPS

Art. No.	Length	Eye Dia.	Breaking Load (kg)
82700	55mm(2-3/16")	10mm(3/8")	160
82701	70mm(2-7/8")	16mm(5/8")	200
82702	80mm(3-3/16")	19mm(3/4")	300
82703	95mm(3-3/4")	22mm(7/8")	380



SWIVEL EYE SNAPS

Art. No.	Length	Swivel Dia.	Breaking Load (kg)
82704	65mm(2-5/8")	10mm(3/8")	150
82705	85mm(3-5/16")	16mm(5/8")	170
82706	100mm(4")	19mm(3/4")	250
82707	120mm(4-3/4")	22mm(7/8")	340



SWIVEL EYE BOLT SNAPS

Art. No.	Size	Breaking Load (kg)
89900	64mm 180	
89901	90mm 650	



DOUBLE SNAP HOOKS

Art. No.	Size	Breaking Load (kg)
89601	90mm 650	



FIXED SNAP SHACKLES

Art. No.	Length	Eye Dia.	Breaking Load (kg)
82812	52mm(2")	12x9mm	1100
82816	66mm(2-5/8")	16x12mm	2000
82822	96mm(3-3/4")	22x16mm	3500



SWIVEL SNAP SHACKLES

Art. No.	Length	Eye Dia.	Breaking Load (kg)
82912	70mm(2-3/4")	12mm(1/2")	1100
82916	87mm(3-1/2")	16mm(5/8")	2000
82922	128mm(5")	22mm(7/8")	3500



SWIVEL JAW SNAP SHACKLES

Art. No.	Size	Breaking Load (kg)
83912	12mm (1/2")	1900
83916	16mm (5/8")	2900
83922	22mm (7/8")	3500



QUICK LINKS

Art. No.	Size	Art. No.	Size
87003	3.5mm	87004	4mm
87005	5mm	87006	6mm
87008	8mm	87009	9mm
87010	10mm	87011	11mm
87012	12mm		



SNAP FENDER HOOKS

Art. No.	Length	Width
17106	1-1/2"	1-5/16"



CABIN HOOKS

Art. No.	Spec.
33855	Cabin Hook 125mm (5")



CLOTHES HOOKS

Art. No.	Spec.
16035	33 x 53mm
16036	25 x 41mm



OPEN HOOKS

Art. No.	Spec.
82967	Horizontal Open Hook 28mm
82963	Vertical Open Hook 9mm
82964	Vertical Open Hook 10mm



"S" HOOKS

Art. No.	Size	Length	S.W.L (Kg)
82803	3mm	34mm	5
82804	4mm	40mm	15
82805	5mm	46mm	20
82806	6mm	52.5mm	30
82808	8mm	62.5mm	50



"S" HOOKS

Art. No.	Size	Breaking Load (kg)
82906	6mm	150
82908	8mm	350
82910	10mm	600

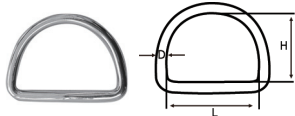

"D" RINGS

Art. No.	D	L	H	Breaking Load (kg)
66425	4mm	25	22	800
66525	5mm	25	22	1000
66640	6mm	40	35	1800
66650	6mm	50	43	1800
66850	8mm	50	43	2800



ROUND RINGS with bar

Art. No.	Size	Breaking Load (kg)
650840-b	8x40mm	4500
651040-b	10x40mm	7000
651050-b	10x50mm	7000
651060-b	10x60mm	7000
651270-b	12x70mm	9600



"S" HOOKS

Art. No.	Size	S.W.L (Kg)
82803-A	3mm(1/8")	5
82804-A	4mm(5/32")	15
82805-A	5mm(3/16")	20
82806-A	6mm(1/4")	30
82808-A	8mm(5/16")	50



DOUBLE SAFETY SPRING HOOKS

Art. No.	Size	Eye	Wt.(g)	Breaking Load (kg)
35050	10x110mm	22mm(7/8")	185	1300



ROUND RINGS

Art. No.	D	H	Breaking Load (kg)
65425	4mm	25	1000
65540	5mm	40	1800
65640	6mm	40	2600
65650	6mm	50	2600
65850	8mm	50	4500
65875	8mm	75	4500
65101	10mm	100	7000
65121	12mm	120	9600



TRIANGLE RINGS

Art. No.	Size	Breaking Load (kg)
67530	5x30mm	1300
67650	6x50mm	2000
67850	8x50mm	2800



HOSE CLAMP band 8mm

Art. No.	Dia.	Art. No.	Dia.
14201	8/12mm	14205	19/29mm
14202	10/16mm	14206	22/32mm
14203	13/19mm	14207	25/38mm
14204	16/25mm		



HOSE CLAMP band 12mm

Art. No.	Dia.	Art. No.	Dia.
14301	16/25mm	14311	70/89mm
14302	19/29mm	14312	76/92mm
14303	22/32mm	14313	80/100mm
14304	25/38mm	14314	90/110mm
14305	32/44mm	14315	100/120mm
14306	35/51mm	14316	110/130mm
14307	38/57mm	14317	120/140mm
14308	44/64mm	14318	130/150mm
14309	51/70mm	14319	140/160mm
14310	64/76mm		



HOSE CLAMP with rolled edges band 9mm

Art. No.	Dia.	Art. No.	Dia.
14001	8/12mm	14012	40/60mm
14002	10/16mm	14013	50/70mm
14003	12/20mm	14014	60/80mm
14004	12/22mm	14015	70/90mm
14005	16/25mm	14016	80/100mm
14006	16/27mm	14017	90/110mm
14007	20/32mm	14018	100/120mm
14008	23/35mm	14019	110/130mm
14009	25/40mm	14020	120/140mm
14010	30/45mm	14021	130/150mm
14011	35/50mm		



HOSE CLAMP with rolled edges band 12mm

Art. No.	Dia.	Art. No.	Dia.
14101	12/22mm	14111	60/80mm
14102	16/25mm	14112	70/90mm
14103	16/27mm	14113	80/100mm
14104	20/32mm	14114	90/110mm
14105	25/38mm	14115	100/120mm
14106	25/40mm	14116	110/130mm
14107	32/44mm	14117	120/140mm
14108	35/50mm	14118	130/150mm
14109	40/60mm	14119	140/160mm
14110	50/70mm		



BLOCKS with single ss sheave

Art. No.	Size	Wt.(g)	Breaking Load (kg)
55025	25mm(1")	150	1500
55032	32mm(1-1/4")	190	1700
55050	50mm(2")	400	3000



BLOCKS with double ss sheave

Art. No.	Size	Wt.(g)	Breaking Load (kg)
55125	25mm(1")	220	1500
55132	32mm(1-1/4")	300	1700
55150	50mm(2")	640	3000



THIMBLE

Art.No.	Size	Art.No.	Size
60002	2mm(3/32")	60010	10mm(3/8")
60003	3mm(1/8")	60012	12mm(1/2")
60004	4mm(5/32")	60014	14mm(9/16")
60005	5mm(3/16")	60016	16mm(5/8")
60006	6mm(1/4")	60020	20mm(3/4")
60008	8mm(5/16")		



HEAVY DUTY CASTED THIMBLE

Art. No.	Size	Wt.(g)
60606	6mm(1/4")	40
60608	8mm(5/16")	50
60610	10mm(3/8")	107
60612	12mm(1/2")	175



WIRE ROPE CLIP

Art. No.	Size	Art. No.	Size
70602	2mm(3/32")	70606	6mm(1/4")
70603	3mm(1/8")	70608	8mm(5/16")
70604	4mm(5/32")	70610	10mm(3/8")
70605	5mm(3/16")	70612	12mm(1/2")



FLUSH LIFT RING

Art. No.	Length	Width	Wt.(g)
35030	48mm(1-7/8")	38mm(1-1/2")	40



FLUSH LIFT RING

Art. No.	Length	Width	Wt.(g)
35031	64mm(2-1/2")	46mm(1-3/4")	85



FLUSH LIFT RING

Art. No.	Length	Width	Wt.(g)
35032	76mm(3")	58mm(2-1/4")	145



PAD EYE OBLONG BASE -casted

Art. No.	Length	Width	Wt.(g)
69211	75mm(3")	22mm(7/8")	69
69212	88mm(3-1/2")	32mm(1-1/4")	135
69213	100mm(4")	36mm(1-3/8")	205



PAD EYE DIAMOND BASE -casted

Art. No.	Length	Width	Wt.(g)
69214	80mm(1-1/8")	50mm(2")	97
69215	90mm(3-1/2")	55mm(2-3/16")	156
69216	100mm(4")	62mm(2-3/8")	223



EYE PLATE with ring or without ring

Art. No.	Diameter	Length	Width	Wt.(g)	Breaking Load (Kg)
69105	5mm	35mm	30mm	38	700
69106	6mm	40mm	35mm	64	1000
69108	8mm	50mm	40mm	58	1600



EYE PLATE ROUND

Art. No.	Size	Breaking Load (Kg)
69305	5x33mm	700
69306	6x40mm	1000
69308	8x50mm	1600



PAD EYE - stamped and welded

Art. No.	Diameter	Length	Width	Breaking Load (Kg)
69205	5mm(3/16")	45mm(1-3/4")	15mm(5/8")	700
69206	6mm(1/4")	60mm(2-3/8")	20mm(3/4")	1000
69208	8mm(5/16")	80mm(3-1/16")	26mm(1")	1600



EYE PLATE DIAMOND SHAPE

Art. No.	Size	Breaking Load (Kg)
69405	5x37x59mm	700
69406	6x50x64mm	1000
69408	8x60x80mm	1600



HEAVY DUTY PAD EYE - Investment Cast

Art. No.	Size	Diameter	Length
32101	9.5mm (3/8")	5mm	48mm(3/8"x1-7/8")



STAPLES - wire stamped

Art. No.	Size	Length
32105	5mm	68mm
32106	6mm	75mm



WIRE EYE STRAPS

Art. No.	Size	Length
32205	5mm	50mm
32206	6mm	60mm
32208	8mm	63mm

STAINLESS STEEL WIRE ROPE



1X19	Art.No.	Size	Reel Metre	Breaking Load (kg)
	56101	5/64"	305m	330
	56102	3/32"	305m	480
	56103	1/8"	305m	850
	56104	5/32"	305m	1300
	56105	3/16"	305m	1900
7x7	56201	5/64"	305m	230
	56202	3/32"	305m	350
	56203	1/8"	305m	580
	56204	5/32"	305m	900
	56205	3/16"	305m	1400
7x19	56301	5/64"	305m	210
	56302	3/32"	305m	320
	56303	1/8"	305m	530
	56304	5/32"	305m	800
	56305	3/16"	305m	1300

CHAIN – General Link

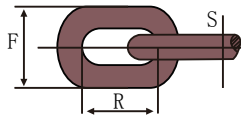

Art. No.	CHAIN SIZE	BREAKING LOAD	LINK DIMENSION			LINKS PER M	LENGTH PER 100KG	
			S	R	F		B.F.	H.D.G.
97203	3	0.06	3.15	15.7	13.1	63.8	511	498
97204	4	0.11	4.00	18.6	16.0	53.9	320	305
97205	5	0.19	5.00	22.0	19.4	45.4	203	193
97206	6	0.32	6.20	26.1	23.5	37.8	129	120
97208	8	0.53	8.00	32.2	29.5	31.0	77.8	74
97210	10	0.83	10.0	39.1	36.2	25.0	48.5	47
97212	12	1.35	12.0	46.0	44.0	21.7	34	33.3
97213	13	1.50	13.0	49.1	46.1	20.3	29.7	27
97216	16	2.31	16.0	59.6	56.5	16.8	20.2	18

CHAIN – Short Link



Art. No.	CHAIN SIZE	BREAKING LOAD	LINK DIMENSION			LINKS PER M	LENGTH PER 100KG	
			S	R	F		B.F.	H.D.G.
97606	6	0.32	6.2	18.9	21.5	52.9	114	108
97608	8	0.53	8.0	24.0	27.5	41.7	70.5	67
97610	10	0.83	10.0	29.5	33.5	33.9	45.2	42.9
97612	12	1.50	12.5	37.5	40.6	26.7	29.5	28.0
97616	16	2.31	16	47.0	54.0	21.3	17.6	16.7

Remark: The real dimensions of chains are not exact same as the above dimensions, the above dimensions are approximate, just for reference. Please note that the breaking load are nominal and should be used as a guide only.



STAINLESS STEEL BRUCE ANCHORS

Art. No.	Weight	Depth	Length	Width
91002	2kg	190mm	365mm	250mm
91005	5kg	240mm	470mm	315mm
91007	7.5kg	273mm	532mm	360mm
91010	10kg	292mm	583mm	385mm
91015	15kg	342mm	655mm	433mm
91020	20kg	375mm	701mm	460mm
91030	30kg	415mm	790mm	520mm



HOT DIPPED GALVANIZED BRUCE ANCHORS

Art. No.	Weight	Depth	Length	Width
91102	2kg	190mm	365mm	250mm
91105	5kg	240mm	470mm	315mm
91107	7.5kg	273mm	532mm	360mm
91110	10kg	292mm	583mm	385mm
91115	15kg	342mm	655mm	433mm
91120	20kg	375mm	701mm	460mm
91130	30kg	415mm	790mm	520mm
91150	50kg	480mm	968mm	643mm
91180	80kg	554mm	1090mm	711mm



STAINLESS STEEL SAND ANCHORS

Art. No.	Weight	Art. No.	Weight
92001-3S	3LB	92008-16S	16LB
92001-4S	4LB	92010-22S	22LB
92002-6S	6LB	92012-27S	27LB
92003-8S	8LB	92016-35S	35LB
92004-10S	10LB	92020-45S	45LB
92006-13S	13LB	92027-60S	60LB

HOT DIPPED GALVANIZED SAND ANCHORS

Art. No.	Weight	Art. No.	Weight
92101-3S	3LB	92108-16S	16LB
92101-4S	4LB	92110-22S	22LB
92102-6S	6LB	92112-27S	27LB
92103-8S	8LB	92116-35S	35LB
92104-10S	10LB	92120-45S	45LB
92106-13S	13LB	92127-60S	60LB



STAINLESS STEEL PLOUGH ANCHORS

Art. No.	Weight	Art. No.	Weight
93005	10LB	93015	35LB
93007	15LB	93022	45LB
93009	20LB	93027	60LB
93012	27LB	93035	80LB



HOT DIPPED GALVANIZED PLOUGH ANCHORS

Art. No.	Weight	Art. No.	Weight
93105	10LB	93115	35LB
93107	15LB	93122	45LB
93109	20LB	93127	60LB
93112	27LB	93135	80LB



STAINLESS STEEL DRAGGEN FOLD ANCHORS Type A

Art. No.	Weight	Art. No.	Weight
90101A	1.5kg	90104A	4kg
90102A	2.5kg	90106A	6kg
90103A	3.2g	90108A	8kg



HOT DIPPED GALVANIZED DRAGGEN FOLD ANCHORS Type A

Art. No.	Weight	Art. No.	Weight
90001A-1	0.7kg	90001A	1.5kg
90002A	2.5kg	90003A	3.2kg
90004A	4kg	90006A	6kg
90008A	8kg	90010A	10kg
90012A	12kg	90015A	15kg



HOT DIPPED GALVANIZED DRAGGEN FOLD ANCHORS Type B

Art. No.	Weight	Art. No.	Weight
90001B-1	0.7kg	90001B	1.4kg
90002B	2.3kg	90003B	3.5kg
90006B	5.5kg	90008B	7.5kg
90010B	10kg		

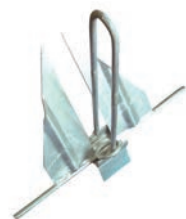

HOT DIPPED GALVANIZED SLIP RING ANCHORS

Art. No.	Weight	Art. No.	Weight
93604	4LB	93605	5LB
93606	6LB	93608	8LB
93613	13LB		



STAINLESS STEEL DELTA ANCHORS

Art. No.	Weight	Art. No.	Weight
96005	5kg	96007	7.5kg
96010	10kg	96015	15kg
96020	20kg	96030	30kg
96050	50kg		



HOT DIPPED GALVANIZED DELTA ANCHORS

Art. No.	Weight	Art. No.	Weight
96104	4kg/9LB	96106	6kg/14LB
96110	10kg/22LB	96116	16kg/35LB
96120	20kg/44LB	96125	25kg/55LB
96132	32kg/70LB	96140	40kg/88LB
96150	50kg/110LB	96163	63kg/140LB



SPLIT BOLLARDS with spring locked captive pin

Art. No.	Base	Height	Pin
99010	62mmx62mm	84mm	without pin
99011	62mmx62mm	84mm	with pin



SOLID BOLLARD

Art. No.	Height	Width	Base Length
99098	90mm	90mm	60mm
99099	115mm	115mm	75mm



Right
30014A/30015A



Left
30014B/30015B

SKENE BOW CHOCKS

Art. No.	Direct	Length	Line Size	Wt.(g)
30014A	right	114mm(4-1/2")	13mm	135
30014B	left	114mm(4-1/2")	13mm	135
30015A	right	152mm(6")	19mm	270
30015B	left	152mm(6")	19mm	270



STRAIGHT CHOCKS

Art. No.	Length	Line Size	Wt.(g)
30010	127mm(5")	16mm	180
30011	152mm(6")	19mm	230
35020	250mm(10")	30mm	1175
35021	350mm(14")	50mm	4800



HEAVY DUTY FLAT CLEATS

Art. No.	Length	Height	Wt.(g)
34004	150mm(6")	28mm	330
34005	200mm(8")	35mm	595
34006	250mm(10")	40mm	1075



HORN BOLLARD

Art. No.	Upper Length	Base Length	Height
33160	160mm(6 3/8")	150mm	55mm
33200	200mm(8")	170mm	75mm
33240	240mm(9 1/2")	200mm	90mm
33300	300mm(12")	260mm	100mm
33350	350mm(14")	300mm	115mm



Right
31014A/31015A



Left
31014B/31015B

SKENE BOW CHOCKS

Art. No.	Direct	Length	Line Size	Wt.(g)
31014A	right	115mm(4-1/2")	23mm	100
31014B	left	115mm(4-1/2")	23mm	100
31015A	right	150mm(6")	35mm	226
31015B	left	150mm(6")	35mm	226



30016

30017

CENTER STANCHION

Art. No.	Tube O.D.	Height	Wt.(g)
30016	22mm(7/8")	38mm(1-1/2")	140
30016B	25mm(1")	38mm(1-1/2")	115

STANCHION SLEEVE WITH EYE

Art. No.	Tube O.D.	Height	Wt.(g)
30017	22mm(7/8")	8mm(5/16")	90
30018	25mm(1")	8mm(5/16")	100

STAINLESS STEEL CLEATS



SLIMLINE BAR CLEATS

Art. No.	Length	Height	Wt.(g)
30002	100mm(4")	25mm	100
30003	125mm(5")	26mm	110
30004	150mm(6")	30mm	220
30005	200mm(8")	35mm	320
30006	250mm(10")	45mm	650
30007	300mm(12")	53mm	1100



39104

CLEATS -studs with nuts

Art. No.	Length	Height	Ø Studs
39104	150mm(6")	40mm	8mm(5/16")
39204	150mm(6")	43mm	8mm(5/16")
30002T	100mm(4")	25mm	6mm(1/4")
30003T	125mm(5")	26mm	6mm(1/4")
30004T	150mm(6")	30mm	8mm(5/16")
30005T	200mm(8")	35mm	10mm(3/8")



"CAMEL" BOLLARD with mounting studs

Art. No.	Length	Centers Distance	Ø Studs
31204	150mm	34.90mm	6mm
31205	200mm	59.60mm	8mm
31206	250mm	75.30mm	10mm
31207	300mm	90.00mm	12mm



LOW FLAT CLEATS with thread holes

Art. No.	Length	Width	Ø Studs
36003A	125mm(5")	15mm	6mm(1/4")
36004A	150mm(6")	20mm	8mm(5/16")
36005A	200mm(8")	23mm	10mm(3/8")



PULL UP CLEATS

Art No.	Length	Deck Raised	Wt.(g)
39003	115mm(4-1/2")	1-5/8"	620
39004	150mm(6")	1-5/8"	630



LOW FLAT CLEATS

Art. No.	Length	Width	Wt.(g)
36003	125mm(5")	15mm	96
36004	150mm(6")	20mm	180
36005	200mm(8")	23mm	320



LOW SILHOUETTE CLEATS

Art. No.	Length	Height	Wt.(g)
31003	125mm(5")	26mm	128
31004	150mm(6")	30mm	340
31005	200mm(8")	45mm	500
31006	250mm(10")	58mm	810



FOLDING CLEAT

Art No.	Tube Size
99109	155mm (6")
99118	200mm(8")

STAINLESS STEEL CANOPY & BIMINI TOP FITTINGS



TOP CAP

Art. No.	Tube O.D.
30074-1	19mm(3/4")
30074-2	20mm
30074	22mm(7/8")
30075	25mm(1")
30076	32mm(1-1/4")



TOP CAP W/HUMP-2 set screws

Art. No.	Tube O.D.	Wt.(g)
38074	22mm(7/8")	136
38075	25mm(1")	138
38076	32mm(1-1/4")	206



JAW SLIDE

Art. No.	Tube O.D.	Pin Size
30080	19mm(3/4")	6mm(1/4")
30081-2	20mm	6mm(1/4")
30081	22mm(7/8")	6mm(1/4")
30082	25mm(1")	6mm(1/4")
30083	32mm(1-1/4")	6mm(1/4")



JAW SLIDE W/HUMP- 2 set screws

Art. No.	Tube O.D.	Wt.(g)
38081	22mm(7/8")	150
38082	25mm(1")	145
38083	32mm(1-1/4")	175



HINGED JAW SLIDE

Art. No.	Tube O.D.	Pin Size
35081	22mm(7/8")	1/4"-20
35082	25mm(1")	1/4"-20
35083	32mm(1-1/4")	1/4"-20
35084	38mm(1-1/2")	1/4"-20
35085	50mm(2")	1/4"-20



SPLIT TYPE SIDE MOUNT with screw nut

Art. No.	Tube O.D.
16008	22mm(7/8")
16009	25mm(1")
16010	32mm (1-1/4")



SLIDE SIDE MOUNT with two set-screws

Art. No.	Tube O. D.	Pin Size
38281	22mm(7/8")	6mm(1/4"-20)
38282	25mm(1")	6mm(1/4"-20)
38283	32mm (1-1/4")	6mm(1/4"-20)



INSIDE EYE ENDS

Art. No.	Tube O.D.	Pin Size	Wt.(g)
30085C	19mm(3/4")	6mm(1/4")	50
30085B	22mm(7/8")	6mm(1/4")	65
30085F	22mm(7/8")	6mm(1/4")	65



DECK HINGE

Art. No.	Base Size	Bolt Size
30086	22x51mm(7/8"X2")	1-1/4"-20
30087	22x51mm(7/8"X2")	no screw



DECK HINGE CONCAVE BASE

Art. No.	Base Size	Bolt Size
30086A	22x51mm(7/8"X2")	1-1/4"
30088A	22x51mm(7/8"X2")	1-1/4"
30090A	22x51mm(7/8"X2")	1-1/4"



DECK HINGE ANGLE BASE

Art. No.	Base Size	Bolt Size	Wt.(g)
30088	22x51mm(7/8"X2")	1-1/4"-20	100
30089	22x51mm(7/8"X2")	no screw	90



DECK HINGE CONCAVE BASE

Art. No.	Base Size	Bolt Size	Wt.(g)
30090	22x51mm(7/8"X2")	1-1/4"-20	100
30091	22x51mm(7/8"X2")	no screw	90



DECK HINGE FOR TUBE 40MM

Art. No.	Base Size	Bolt Size	Wt.(g)
35086	22x51mm(7/8"X2")	1-1/4"-20	101
36086	22x51mm(7/8"X2")	1-1/4"-20	105



DECK HINGE HEAVY DUTY 4-HOLE

Art. No.	Bolt Size	Style	Wt.(g)
38086	1-1/4"-20	with screw	205
38087	1-1/4"-20	no screw	195



HEAVY DUTY DECK HINGE PLATE

Art. No.	Tube O.D.	Pin Size	Wt.(g)
30093	1-7/8"X2-3/4"	5/16"	160



DECK HINGE SIDE MOUNTED

Art. No.	Base Size	Bolt Size	Wt.(g)
30098	22x51mm(7/8"X2")	1-1/4"-20	65



EXTRA HEAVY DUTY DECK HINGE PLATE

Art. No.	Tube O.D.	Pin Size	Wt.(g)
30094	1"X2-1/8"	5/16"	100



WINDSHIELD SIDE MOUNT WITH BOLT

Art. No.	Length	Height	Wt.(g)
35096	2-3/8"	1-1/2"	77
35097	2-3/8"	1-3/4"	68



ADJUSTABLE DECK HINGE WITH BOLT

Art. No.	Base Size	Bolt Size	Wt.(g)
35095	1"X2-3/4"	1-1/4"-20	180



ADAPTER FOR TUBE

Art. No.	Tube O.D.	Wt.(g)
99002	7/8" & 1"	75



FRAME TUBE HINGE (Joint) with Quick Release locking Pin

Art. No.	Direct	Wt.(g)
38222	22mm(7/8")	210
38225	25mm(1")	250



CAST HINGES with Buna type O-rings

Art. No.	Spec.
38201	7/8"
38202	1"



16003

Art. No. Spec. Wt.(g)

16001	Adjustable Top Cap with right thread 22mm	237
16002	Adjustable Top Cap with right thread 25mm	238
16003	Swivel Hinge with cross bolt and round mount	130
16004	Swivel Hinge with cross bolt and Oblong mount	130

HATCH HINGE STANDARD

Art. No.	Size	Wt.(g)
30099	76x64mm (3"x2-1/2")	250

STAINLESS STEEL DECK HINGES



BOAT RAILING FITTING ROUND BOSS
 Art. No. Length width Height
 37090 2-1/4" 7/8" 1-7/16"



BOAT RAILING FITTING FORKS
 Art. No. Length width Height
 38090 2-1/4" 7/8" 1-3/8"



ROCKET LAUNCHER BASE 2 Bolt
 Art. No. Size Thread
 99029 80x25mm 8mm



ROCKET LAUNCHER BASE 4 Bolt
 Art. No. Size Thread
 99030 80x60mm 8mm



SHOWER DRAIN IN STEPPED TUBE
 Art. No. Plate Dia. Tube Dia.
 35112 70mm 19mm



FOLDING STEP
 Art. No. Size Wt.(g)
 35033 110X55mm(4-3/8"x2-1/8") 556



FLUSH CATCH without lock
 Art. No. Size
 99028 50mm



ROUND PLATE DECK HINGE
 Art. No. Size Wt.(g)
 30161 2-1/2"x2-1/2" 130
TAKE APART MOTOR BOX HINGE
 Art. No. Size Wt.(g)
 30107 1-1/2"x 3-1/2" 180

STAINLESS STEEL DECK HINGES



DOOR HINGE
 Art. No. Size Wt.(g)
 30105 38x76mm(1-1/2"x3") 70
 30106 38x102mm(1-1/2"x4") 110



DOOR HINGE
 Art. No. Size Wt.(g)
 30112 38x56mm(1-1/2" x 2-1/4") 70
 30113 38x76mm(1-1/2" x 3") 90



OFFSET HINGE
 Art. No. Offset Size Wt.(g)
 30095 3/8" 1-1/2"x2-1/4" 60
 30096 3/8" 1-1/2"x2-3/4" 70



DOOR HINGE
 Art. No. Size Wt.(g)
 99005 70x40mm 77



DOOR HINGE with thread stud
 Art. No. Size Wt.(g)
 99006 70x40mm 117



DOOR HINGE with thread stud
 Art. No. Size Wt.(g)
 99007 125x39.5mm 139



BUTT HINGE
 Art. No. Size Wt.(g)
 30108 38x38mm(1-1/2 x 1-1/2") 40
 30109 50x50mm(2 x 2") 60



STRAP HINGE
 Art. No. Size Type Wt.(g)
 30110 100x25mm(4" x 1") no screw 80
 30111 150x30mm(6" x 1-1/8") no screw 120
 30111B 150x30mm(6" x 1-1/8") with screw 120



RECTANGULAR BASE 90°

Art. No.	Tube O.D.	Base	Wt.(g)
30035	22mm(7/8")	3"X1-3/4"	200
30036	25mm(1")	3-1/4"X1-7/8"	250



ROUND BASE 90°

Art. No.	Tube O.D.	Base	Wt.(g)
30038	22mm(7/8")	2-5/8"	200
30039	25mm(1")	2-3/4"	210



FLAG POLE SOCKET TOP MOUNTED

Art. No.	Tube O.D.	Base	Wt.(g)
30040	25mm(1")	2-5/8"	250



ROUND BASE 30°

Art. No.	Tube O.D.	Base	Wt.(g)
30043	22mm(7/8")	2-5/8"	210
30044	25mm(1")	2-3/4"	240



ROUND BASE 45°

Art. No.	Tube O.D.	Base	Wt.(g)
30045	22mm(7/8")	2-5/8"	210
30046	25mm(1")	2-3/4"	250



ROUND BASE 60°

Art. No.	Tube O.D.	Base	Wt.(g)
30047	22mm(7/8")	2-5/8"	210
30048	25mm(1")	2-3/4"	270



RECTANGULAR BASE 30°

Art. No.	Tube O.D.	Base	Wt.(g)
30049	22mm(7/8")	3"X1-3/4"	210
30050	25mm(1")	3-1/4"X1-7/8"	250



RECTANGULAR BASE 45°

Art. No.	Tube O.D.	Base	Wt.(g)
30051	22mm(7/8")	3"X1-3/4"	190
30052	25mm(1")	3-1/4"X1-7/8"	240



RECTANGULAR BASE 60°

Art. No.	Tube O.D.	Base	Wt.(g)
30053	22mm(7/8")	3"X1-3/4"	190
30054	25mm(1")	3-1/4"X1-7/8"	240



LEFT TEE 60°

Art. No.	Tube O.D.	Wt.(g)
30055	22mm(7/8")	185
30056	25mm(1")	200



UNIVERSAL TEE 60°

Art. No.	Tube O.D.	Wt.(g)
30057	22mm(7/8")	176
30058	25mm(1")	200
30058-3	32mm(1-1/4")	313



TEE 90°

Art. No.	Tube O.D.	Wt.(g)
30059	22mm(7/8")	160
30060	25mm(1")	185
30060-3	32mm(1-1/4")	201



RIGHT TEE 60°

Art. No.	Tube O.D.	Wt.(g)
30061	22mm(7/8")	185
30062	25mm(1")	200



ELBOW 90°

Art. No.	Tube O.D.	Wt.(g)
30063	22mm(7/8")	130
30064	25mm(1")	190



3-WAY CORNER FITTING

Art. No.	Tube O.D.	Wt.(g)
30020	22mm(7/8")	190
30021	25mm(1")	240



BOW FORMS

Art. No.	Tube O.D.	Degree	Wt.(g)
30065	22mm(7/8")	110°	280
30066	22mm(7/8")	125°	300
30067	22mm(7/8")	140°	340
31065	25mm	110°	280



CENTER 60° STANCHION

Art. No.	Tube O.D.	Height	Wt.(g)
30025	22mm(7/8")	38mm(1-1/2")	110
30026	25mm(1")	44mm(1-3/4")	140



AFTER 60° STANCHION

Art. No.	Tube O.D.	Height	Wt.(g)
30027	22mm(7/8")	38mm(1-1/2")	110
30028	25mm(1")	44mm(1-3/4")	150



END 120° STANCHION

Art. No.	Tube O.D.	Hole Dia.	Wt.(g)
30031	22mm(7/8")	38mm(1-1/2")	110
30032	25mm(1")	44mm(1-3/4")	150



END 60° STANCHION

Art. No.	Tube O.D.	Wt.(g)
35027	22mm(7/8")	148



CENTER STANCHION

Art. No.	Tube O.D.	Wt.(g)
35016	22mm(7/8")	93
35017	25mm(1")	100



HEAVY DUTY STANCHION BASE

Art. No.	Size	Angle
99119	25mm (1")	5°



END BOTTOM MOUNTED 90°

Art. No.	Tube O.D.	Height	Wt.(g)
36010	22mm(7/8")	38mm(1-1/2")	375
36011	25mm(1")	38mm(1-1/2")	388



CENTRAL HANDRAIL SUPPORT

Art. No.	Tube O.D.	Wt.(g)
35001	22mm(7/8")	236
35002	25mm(1")	356



END HANDRAIL SUPPORT

Art. No.	Tube O.D.	Wt.(g)
35003	22mm(7/8")	250
35004	25mm(1")	377



STANCHION CAP

Art. No.	Tube O.D.	Hole Dia.	Wt.(g)
30022	22mm(7/8")	6mm(1/4")	80
30023	25mm(1")	6mm(1/4")	110



STANCHION BASE

Art. No.	Upper Stud	Thread
17101	22mm	12mm



BULLET END PLUG

Art. No.	Tube O.D.	Height	Wt.(g)
30024	22mm(7/8")	22mm(1-1/2")	40



STANCHION BASE

Art. No.	Thread	Upper Stud	Length
35098	14mm	22.00mm	40mm



FRAMES 90° with thread hole

Art. No.	Tube O.D.	Base	Height
15025	25mm(1")	44mm	70mm
15030	32mm(1-1/4")	51mm	80mm



FRAMES 60° with thread hole

Art. No.	Tube O.D.	Base	Height
15014	25mm(1")	53x46mm	70mm



FRAMES 60° with thread hole

Art. No.	Tube O.D.	Base	Height
15015	32mm(1-1/4")	66x51mm	80mm



35018
35019

HAWSE PIPE

Art. No.	Outside Dia.	Inside Dia.
35018	5-1/2"x2-1/2"	3-3/4"x1-1/2"
35019	6"x3-1/4"	2"x4"



ANCHOR SWIVEL 3-way

Art. No.	Chain size
99025	6-8mm



HOSE DECK FILLS WITH KEY

Art. No.	Dia.	Flange	Type
30101	38mm(1-1/2")	3"	Gas
30101F	38mm(1-1/2")	3"	Fuel
30102	38mm(1-1/2")	3"	Diesel
30103	38mm(1-1/2")	3"	Water
30104	38mm(1-1/2")	3"	Waste



HOSE DECK FILLS WITH KEY

Art. No.	Dia.	Flange	Type
30201	50mm(2")	3"	Gas
30201F	50mm(2")	3"	Fuel
30202	50mm(2")	3"	Diesel
30203	50mm(2")	3"	Water
30204	50mm(2")	3"	Waste



HOSE DECK FILLS with star cap

Art. No.	Diameter	Type	Flange
30301	38mm(1-1/2")	Gas	85mm
30302	38mm(1-1/2")	Diesel	85mm
30303	38mm(1-1/2")	Water	85mm
30304	38mm(1-1/2")	Waste	85mm



HOSE DECK FILLS with star cap

Art. No.	Diameter	Type	Flange
30401	50mm(2")	Gas	85mm
30402	50mm(2")	Diesel	85mm
30403	50mm(2")	Water	85mm
30404	50mm(2")	Waste	85mm



THROUGH HULL OUTLETS

Art. No.	Size	Art. No.	Size
33101	3/8"	33105	1-1/4"
33102	1/2"	33106	1-1/2"
33103	3/4"	33107	2"
33104	1"		



INTAKE STRAINERS

Art. No.	Size	Art. No.	Size
33201	3/8"	33205	1-1/4"
33202	1/2"	33206	1-1/2"
33203	3/4"	33207	2"
33204	1"		



LONG THROUGH HULL OUTLETS

Art. No.	Diameter	Thread Length	Flange
33124	25mm(1")	60mm	55mm
33114	25mm(1")	107mm	55mm
33115	32mm(1-1/4")	112mm	64mm
33116	38mm(1-1/2")	112mm	71mm



THROUGH HULL OUTLETS with hose connection

Art. No.	Size	Art. No.	Size
33501	3/8"	33504	1"
33502	1/2"	33505	1-1/4"
33503	3/4"	33506	1-1/2"



ANTENNA RATCHET MOUNT

Art. No.	Height	Base
35038	5"	2"x3-1/2"



HEAVY DUTY ANTENNA MOUNT

Art. No.	Height	Base
35039	6"	2-1/4"X3-3/4"



ANTENNA RAIL MOUNT

Art. No.	Height	Width
35037	3-1/2"	2-1/2"



ANTENNA RAIL MOUNT

Art. No.	Height	Wt.(g)
35037A	3-1/2"	440



DECK PLATE

Art. No.	Size
35009	4"
35010	5"
35011	6"



BASE FOR LIGHTPOLE

Art. No.	Size	Art. No.	Size
35041	60mm	35043	60mm
35042	60mm		



RAIL END CAPS
 Art. No. Length
 99051 95mm
 99052 95mm



RAIL END CAPS
 Art. No. Direct
 15002 left
 15003 Right



RAIL END CORNER CAPS
 Art. No. Logo
 99013 with no logo



RUB RAIL CAPS
 Art. No. Logo
 35110 with no logo



RUB RAIL END CAPS
 Art. No. Length Logo
 35109 4" with no logo



RUB RAIL END CAPS
 Art. No. Size
 11893 3.815"x2.6"



DOUBLE WIRE ROD HOLDER
 Art No. Wire Diameter
 99018 6mm



TUBE ROD HOLDER
 Art No. Type
 99132 Casted



ADJUSTABLE SINGLE RAIL MOUNT ROD HOLDER
 with rotates 360° both horizontal and vertical
 Art No. Tube Size
 99117 25mm (1")
 99136 32mm(1-1/4")



ADJUSTABLE SINGLE DECK MOUNT ROD HOLDER
 with rotates 360° horizontal and 270° vertical
 Art No. Base Size
 99217 95x57mm



ADJUSTABLE SINGLE RAIL MOUNT ROD HOLDER
 with rotates 360° both horizontal and vertical
 Art No. Tube Size
 99138 25mm (1")
 99139 32mm(1-1/4")



ADJUSTABLE SINGLE TUBE DECK MOUNT ROD HOLDER
 with rotates 360° horizontal and 270° vertical
 Art No. Base Size
 99238 95x57mm



STAINLESS STEEL ROD HOLDER & ROPE



3-Way ROD HOLDER - port & starboard mounts

Art No.	Tube Diameter	Wire Diameter
99080	25mm/32mm	6mm



ADJUSTABLE 3-WAY ROD HOLDER

Art No.	Horizontal Rotation	Vertical Rotation
99111	360°	180°



ADJUSTABLE 3-WAY RAIL MOUNT ROD HOLDER

Art No.	Horizontal Rotation	Vertical Rotation
99112	360°	360°



SLIMLINE ROD HOLDER

Art. No.	Degree	Flange	Height
99038	90°	80x60mm	215mm
99039	15°	80x60mm	215mm
99040	30°	80x60mm	215mm



ROD HOLDER FLUSH MOUNT

Art. No.	Degree	Plate	Height
30042A	30°	4-1/4"X3-3/8"	8"
30042B	90°	4-1/4"X3-3/8"	8-5/8"
30042C	15°	4-1/4"X3-3/8"	8-1/2"



SILVER ANCHOR ROPE (polyethylene staple)

Art. No.	Dia.	Length	Breaking Load
186061	6mm	50m	350kg
186081	8mm	50m	550kg
186101	10mm	50m	800kg
186121	12mm	50m	1000kg

Terms & Conditions

Definitions:

In these terms and conditions unless the contact otherwise requires:

- (a) "The Supplier" means Frank Marine Pty Ltd.
- (b) "The Purchaser" means the person, firm, company or organisation to whom a quotation is submitted by the Supplier or who places an order with the Supplier.
- (c) "The goods" means all items supplied by Frank Marine Pty Ltd. pursuant to the supplier's written quotation or published price list.
- (d) "Authorised number for return" means the number quoted to the purchaser by the Supplier for the return of the goods.

1. Prices

Prices referred to as retail are recommended retail prices only and there is no obligation to comply with the recommendation. Prices referred to as trade are current at the date of publication of the latest price list but may vary due to variations in cost due to the nature of importing and distribution. The Supplier reserves the right to change the price in the event of a variation to the Supplier's quotation. Any variation from the plan of scheduled works or specifications (including, but not limited to, any variation due to unforeseen circumstances, or due to fluctuations in currency exchange rate will be charged for on the basis of the Supplier's quotation and will be shown as variations on the invoice. Payment for all variations must be made in full.

2. Application of Terms and Conditions

Unless otherwise agreed by the Supplier in writing the terms and conditions hereof shall apply to all orders placed with the supplier. Any stipulation on the purchase's order form which conflicts with any of these terms and conditions or in any way qualifies or negates the same shall be deemed to be inapplicable to any order placed with the Supplier unless agreed to in writing by the Supplier prior to delivery of the goods.

3. Stock of the Goods

The supplier does not have all the goods showed in this catalogue in stock, it means that not all the items in this catalogue are available in the Supplier' warehouse. The prices, quantity and shipment date of the goods are subjected to the Seller's final confirmation. The Purchaser must send an inquiry to the Seller for the Seller's final confirmation before ordering.

4. Notice of Delivery

The purchaser agrees to ascertain the estimated delivery date of the goods purchased at the time of placing an order and acknowledges that the delivery will depend upon availability of stocks. The supplier will send the purchaser notice of delivery by e-mail or by fax within two working days after delivery.

5. Delivery

Unless otherwise agreed to by the Supplier, delivery of the goods shall be deemed to be effective when the goods are assembled and ready for despatch at the Suppliers premises. The Supplier may deliver or arrange delivery of goods to the Purchaser at the Purchasers request and expense. All goods are sold Ex warehouse.

6. Shortages

The Purchaser hereby agrees to verify all goods received against carriers consignment notes immediately upon unloading at destination. The Supplier accepts no responsibility if incorrect parcel count is signed for. No claim for shortages or improper goods will be recognised by the Supplier unless notified to the Supplier within forty-eight hours of delivery.

7. Defects

The Purchaser shall inspect the Goods on delivery and shall within two (2) days of delivery (time being of the essence) notify the Seller of any alleged defect, shortage in quantity, damage or failure to comply with the description or quote. The Purchase shall afford the Seller an opportunity to inspect the Goods within a reasonable time following delivery if the Purchaser believes the Goods are defective in any way. If the Purchaser shall fail to comply with these provisions that the Goods shall be presumed to be free from any defect or damage. For defective Goods, which the Seller has agreed in writing that the Purchaser is entitled to reject, the Seller's liability is limited to either (at the Seller's discretion) replacing the Goods or repairing the Goods except where the Purchaser has acquired Goods as a consumer within the meaning of the Competition and Consumer Act 2010 (Cwth) or the Fair Trading Acts of the relevant state or territories of Australia, and is therefore also entitled to, at the consumer's discretion either a refund of the purchase price of the Goods, or repair of the Goods, or replacement of the Goods. The Seller shall not be responsible for any labour charges incurred in replacing any defective Goods.

8. Return of Goods

Prior authorisation of the Supplier must be obtained before returning any goods. All returns must be accompanied by the original delivery docket or invoice and "Authorisation for return" number quoted. A handling charge of 15% will be applied to all returns. Non standard goods and cut lengths can not be returned. Goods must be in new condition in their original boxes. Goods must be returned by our nominated carrier within 14 days of invoice.

9. Purchaser's Acknowledgements

The Purchaser acknowledges that:-

- (a) He does not rely upon the Suppliers skill or judgement in relation to the purposes for which the goods are required.
- (b) The goods may not produce satisfactory results if they are not used strictly in accordance with the Suppliers instructions or if deteriorated goods are used the Supplier accepts no liability or responsibility for such incorrect use of the goods
- (c) All descriptive specifications, illustrations, drawings, data, dimensions and weights furnished by the Supplier or contained in any catalogue, price list or other advertising material of the Supplier are approximate only and are intended to be by way of general description of the goods and shall not form part of the contract unless certified by the Supplier in writing in which case they shall be subject to recognised tolerances.
- (d) The Seller does not test the breaking load of the goods, please note that the breaking load in this catalogue are nominal and should be used as a guide only. The purchase must test the goods before using them. The Purchase bears all costs and risks of loss of, or damage caused by the goods.

10. Payment

Payments for all the orders are made before delivery, unless the Purchasers have account with the Supplier.

11. Specifications

The Supplier reserves the right to change products, models, specifications and options without notice. No responsibility can be accepted for printing or dimension discrepancy.

12. Guarantee

Every item stocked by the Supplier is guaranteed to be free from defect at the time of shipment. Any item considered by the Supplier to be defective will be replaced or adjustment made provided we are notified promptly (7 days) upon receipt and, if we request, the item is to be returned to us for examination. This guarantee is void if repairs are attempted by anyone other than the Supplier. Supplier will not be responsible for labour charges incurred in the replacement of any item. In no event will the Supplier be liable for defects in any item which exceed its replacement cost to the Supplier. Items used on hire, charter or commercial craft are excluded from the terms of this guarantee.

13. Warranties

The Supplier agrees to be bound only by those conditions or warranties expressly agreed to in writing between the contracting parties and those imposed and required to be binding by statute (including the Trade Practices Act) and the extent permitted thereby. Liability (if any) of the Supplier arising from the breach of such conditions or warranties shall, at the Suppliers option, be limited to and completely discharged by either the replacement or repair (or the payment of the cost of the replacement or repair) by the Supplier of the goods supplied to the Purchaser.

14. Risk and Title

All risk for the Goods passes to the Purchase on delivery. Notwithstanding that the risk in the goods shall pass to the Purchaser as herein provided, title to the goods shall remain with the Supplier until all monies due under any contract between the Supplier and the Purchase are paid in full. If the Supplier's written demand for payment remains unsatisfied for a period of seven (7) days from the date of the demand the Supplier shall be entitled to enter the premises occupied by the Purchaser to recover any goods which are the property of the Supplier and which the Supplier reasonably believes to be on such premises provided that where any payment is made by cheque, the payment shall not have been made until the cheque has been honoured upon presentation.

15. Other Dealings

Subject to express contrary agreement in writing and signed on behalf of the Supplier these terms and conditions shall so far as is applicable and making all changes necessary having regard to the context be incorporated in any contract arising from future orders placed by the Purchase with the Supplier.

16. Limited Contracts

The foregoing terms and conditions contain the whole of the terms upon which the goods are supplied (subject only to any express special terms or variations given in the Supplier written condition or on the delivery document); constitute an entire agreement between the parties and shall supersede all previous and other communications and representations either overall or in writing.

17. Copyright

The catalogue is subject to copyright to the Supplier, no person, firm, company or organisation may reproduce any part of it without written consent from the Supplier.